

51775.

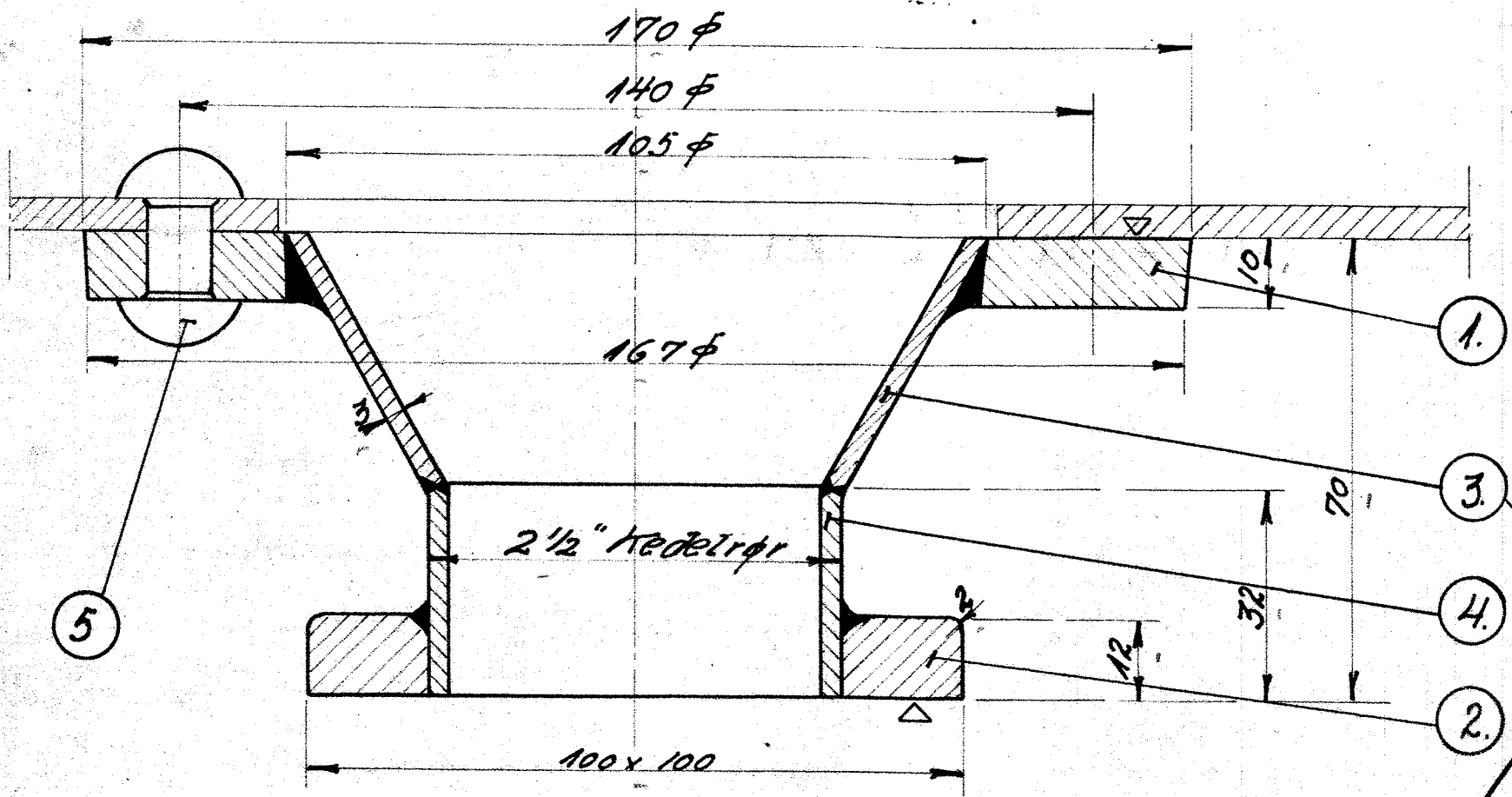

1.	1.	Flange	Flussj	180x180 x10.
2.	1.	Ø.	"	105x105 x13
3.	1.	Tragt	"	220x110 x3
4.	1.	Rør	"	Kødelrør 2 1/2" x 40
5.	16	Nagle. 10 φ x 30.	Nittet	Best.

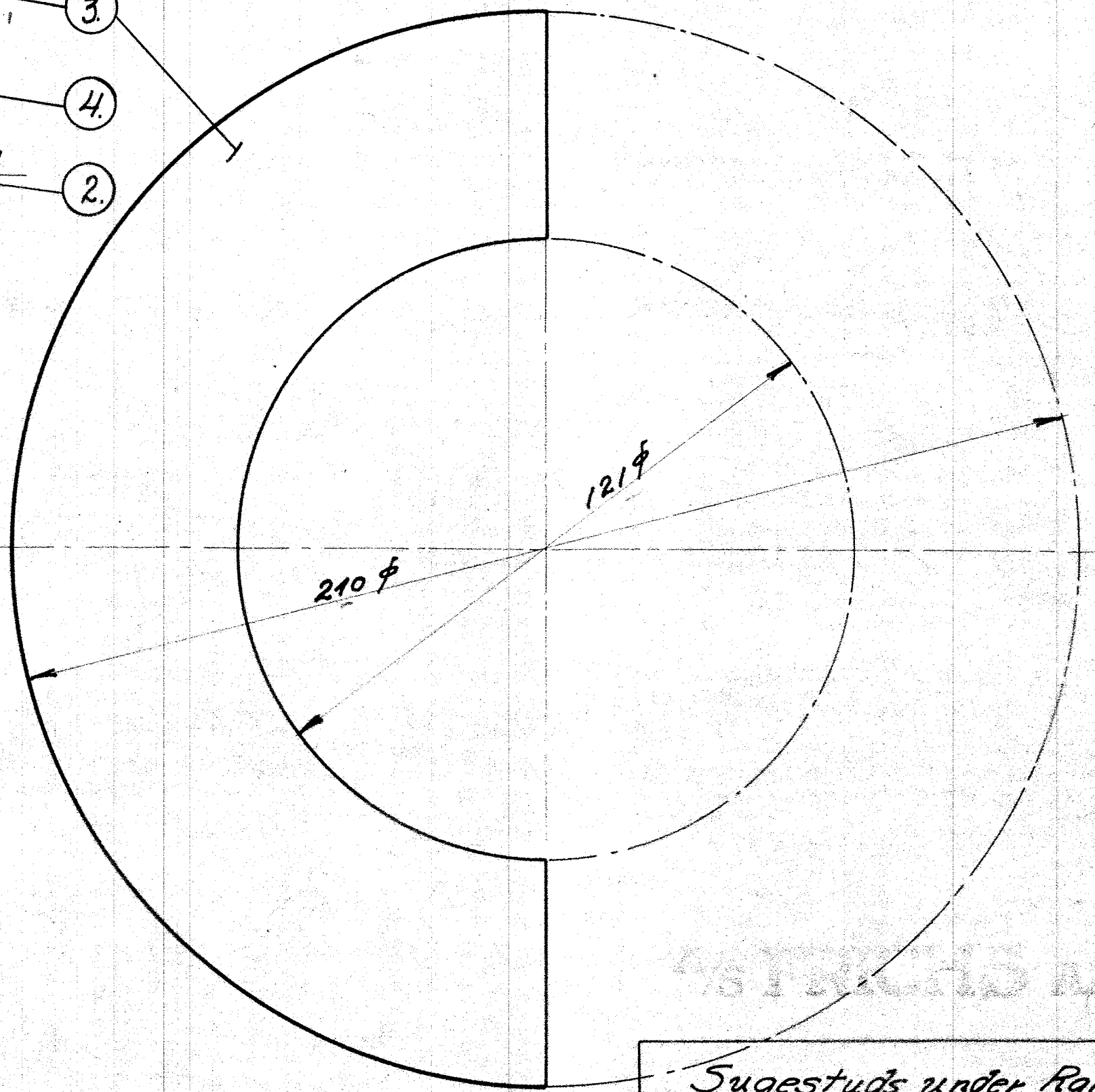
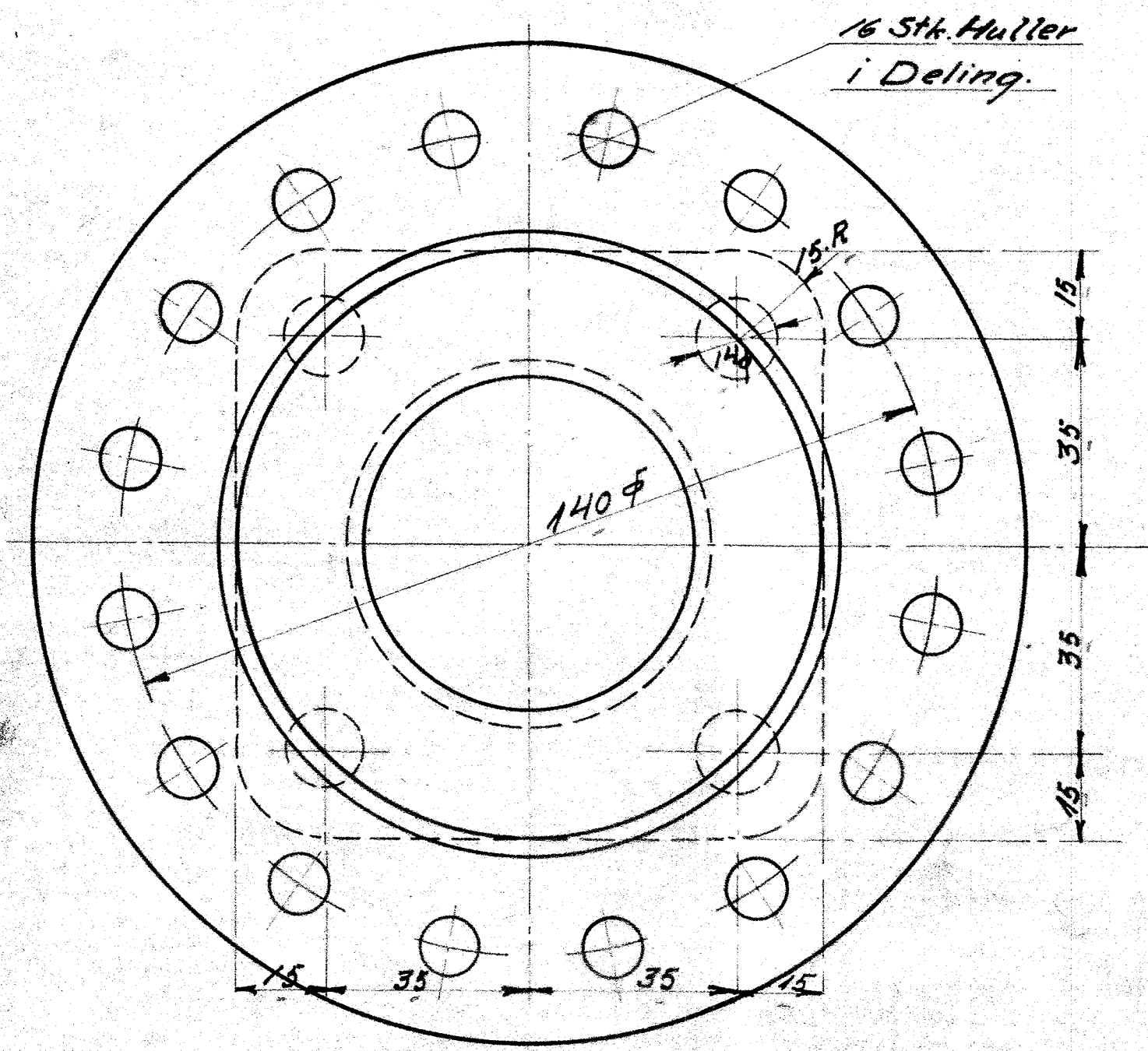

Sugestuds under Rammeland.			
Kasse Diesel-el 375K. Motorloke			
A.K.			
K.F.			
Skala	1:1		117L-16.14.
29-3-32			